

F

CLASS



EXPERIENCE THE
EXCEPTIONAL

Your yacht is an extension of yourself. A statement of your lifestyle. She needs to deliver unforgettable experiences for you, your family and friends. Every Princess yacht is designed with our forward-thinking mentality and crafted with meticulous attention to detail. So whether you're dashing across the water or moored in your favourite bay, you will recognise the difference our design and details make, inside and out.

Experience the exceptional.



CRAFTED IN PLYMOUTH

Perched on the edge of the English Channel lies the city of Plymouth, where we established our home in 1965. Today Princess shipyards cover an area of over 1.1 million square feet, an area rich in British maritime heritage. In fact, South Yard, where our X Class Super Flybridge yachts are constructed, is a former naval yard dating back to the 17th century. From the outset, our goal has been to meticulously sculpt our yachts around our owners' enjoyment of them. Such dedication and attention to detail resonates deeply with our Plymouth craftspeople.

Over 3,000 people, each possessing a mastery of their skill, fastidiously realise this vision in our shipyards. Through a culture of innovation, our yachts are not only some of the most technically-advanced in the world but also the most beautifully realised.



BEAUTY IS ALWAYS IN THE DETAIL

We are determined to develop ever more ingenious ways to ensure every last millimetre of your boat is ergonomically sound, highly practical, and spatially perfect. Once our team of naval architects, designers and engineers have determined a design, our craftspeople fastidiously bring it to life. Every beautiful detail is crafted and finished within our Plymouth shipyards. This enables us to consistently monitor quality throughout each build. Seeing is believing though, so we invite future owners to pay us a visit and see beauty in progress through their own eyes.





F CLASS

Experience the most technically advanced and spaciouly proportioned flybridge yachts on the water. Every Princess flybridge yacht rewrites the rule book on space, performance and entertaining. Wonderfully progressive, incredibly efficient, classically Princess.



F 55



Equipped with twin Volvo D13-900 engines providing speeds up to 33 knots, in addition to a deep-V resin-infused hull, the F55 delivers dynamic and effortless seakeeping.

As seen on larger yachts in the range, the cockpit servery unit connects to the galley unit, seamlessly integrating the two entertainment areas. The spacious main deck saloon is accentuated by vast saloon windows, complemented by subtle accent lighting, soft fabric finishes and hand-stitched detailing. A contemporary U-shaped sofa with convertible coffee/dining table and sofa adjacent, creates the perfect place to spend time with loved ones.





Below deck, new expansive hull windows generously flood the three cabins with light, including the master stateroom with dressing table, breakfast area and en-suite bathroom, a forward double guest cabin and starboard twin cabin with the option of a double bed conversion. An optional single aft cabin with en-suite and storage is ideal for crew.





TAKE A VIRTUAL TOUR OF THE F55





F55
SPECIFICATION

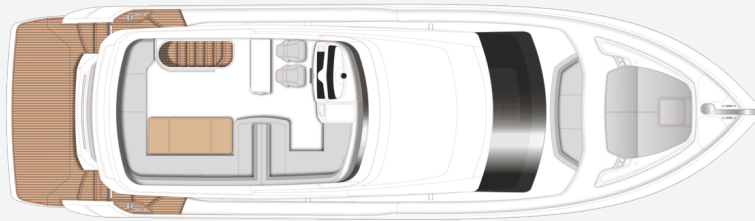

F55 Flybridge

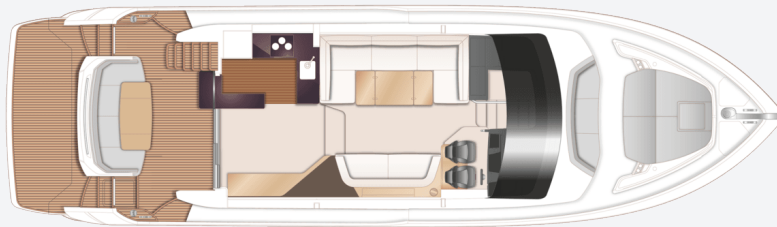

F55 Main Deck

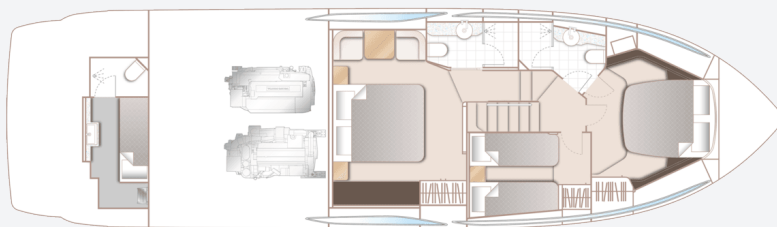

F55 Lower Deck

PRINCIPAL DIMENSIONS

Length overall (incl. pulpit)	58ft 0in (17.68m)
Length overall (excl. pulpit)	55ft 8in (16.98m)
Beam	16ft 0in (4.87m)
Draft (at full load) approx.	4ft 7in (1.41m)
Displacement approx.	30,924kg (68,176lbs)*
Fuel capacity	605 gal/726 US gal/2,750l
Water capacity (excl. calorifier)	136 gal/164 US gal/620l

ENGINES

Twin Volvo D13-900 (2 x 900mhp)	Speed range: 32-34 knots†
--	------------------------------

FULL SPECIFICATION

DECK FITTINGS

- Teak-laid transom platform, cockpit deck, flybridge stairway and steps to side deck
- Reversible electric anchor winch with foredeck and helm position controls
- Stemhead roller with automatic anchor launch and retrieve
- Self-stowing (25kg/55lb) galvanised Lewmar Delta anchor with 40m of galvanised 9.5mm anchor chain
- Bow rope storage locker
- Freshwater deck/anchor wash
- Walk through coachroof seating area
- Foredeck sunbathing area
- Deck storage locker for fenders and ropes
- Stainless steel bow, stern and spring cleats (8)
- Stainless steel pulpit and guardrails
- Stainless steel coachroof handrails
- Foredeck hatch
- PVC rubbing band with stainless steel insert
- LED deck level lighting
- Illuminated crown logo to transom
- Full set of IMCO navigation lights

- Riding light
- Searchlight with remote control
- Twin electric horns
- Loudhailer
- Fuel and water fillers

COCKPIT AND BATHING PLATFORM

- Self-draining
- U-shaped seating/dining area with folding teak table
- LED overhead and deck level lighting
- Stainless steel handrails
- Rope stowage locker
- Lockable gas strut assisted hatch to lazarette/engine room
- Lockable gas strut assisted hatch to lazarette/optional crew cabin
- Locker containing remote fuel cocks, manual bilge pump with valve chest and manual controls for automatic fire extinguishers
- Twin transom doors leading to bathing platform
- Retractable bathing ladder (manual) in side of bathing platform

- Transom steps to access stern from bathing platform when in lowered position
- Hot and cold transom shower
- 220/240v shore support inlet in locker
- Cockpit cover

FLYBRIDGE

- Dual station instrumentation and controls with 16" Garmin screen displaying engine instrumentation, fuel gauges, rudder position indicator and chartplotter (either individual or combined)
- Adjustable steering wheel
- Top loading coolbox adjacent to helm
- Audible and visual alarm for bilge pumps
- Twin helm seats with fore and aft adjustment for helmsman
- U-shaped upholstered seating starboard fore (converts to sunbed)
- U-shaped upholstered seating area starboard aft
- Teak folding table
- Fusion MS-SRX400 audio system with

waterproof Fusion signature 6.5" speakers

linked to saloon audio unit

- Wetbar including sink, stowage and optional electric barbecue
- Clear view hatch to aft cockpit
- Wind deflector screens
- Stainless steel handrails
- Stainless steel handrail forward of flybridge hatch
- LED deck level lighting
- GRP radar arch
- Matched whip aerials for VHF R/T and radio
- Liferaft stowage
- ROKK twin USB socket
- Console and seat covers
- Optional GRP hardtop with/without electric opening section (or optional folding bimini with optional electro-hydraulic operation)

LOWER HELM POSITION

- Twin helm seats with fore and aft adjustment for helmsman
- Instrument console with 16" Garmin screen displaying engine instrumentation, fuel gauges, rudder position indicator and chartplotter (either individual or combined)

- Volvo engines have a 7" display for engine instrumentation at both control positions. The 16" screen incorporates Volvo software to allow engine instrumentation and autopilot function displays, as well as the 7" display. If a second 16" screen is ordered it will be fitted immediately in front of the helm position with the engine instrumentation display to starboard.
- Dual station instruments and controls at Flybridge and Lower Helm Positions:
 - power-assisted electric steering with Volvo joystick control
 - adjustable steering wheel
 - high-speed magnetic compass
 - electronic engine controls
 - trim tab controls with indicators
 - bow thruster control
 - electric anchor winch remote control
 - autopilot (incorporated into 16" screen at both control positions)
 - speed and distance log (incorporated into 16" screen at both control positions)
 - echo sounder with alarm
 - VHF with DSC R/T with intercom
 - remote control searchlight
 - horn button

- teak footrest

- Drinks holders
- Toughened glass screen (clear for night vision)
- Windscreen wipers with freshwater windscreen wash
- Black mesh sunscreens
- Bilge pump controls with visual pump running warnings
- 24v and 240v electrical control panel
- Riding light, helm and navigation light control switches
- Twin USB connection point (was single)
- LED overhead lighting (24v) and night lighting
- Electric drop window
- Fitted carpet

DECK SALOON

- U-shaped sofa
- Folding leaf dining table or coffee table
- Electric drop window (port)
- Two-seater sofa
- Crockery storage drawer
- Sideboard unit
- UHD LED TV (50") on rise and fall
- Apollo MS-RA670 audio system, with WiFi/DAB and external USB socket. Paired with Fusion 6"

MS-CL602 speakers (2)

- Blinds or sunscreens to all windows and doors
- LED overhead and concealed lighting (24v)
- Access stairway to lower accommodation
- Fitted carpet

GALLEY

- Solid Surface counter top in Sylmar white
- Ceramic 4-zone hob
- Hob extractor
- Combination microwave/convection oven with grill
- Stainless steel sink with mixer tap
- Full height fridge/freezer (270l)
- Waste bin
- Drawers and storage cupboards
- Sideboard unit with bottle and glass storage
- Refrigerator
- Stainless steel framed sliding door to cockpit with integrated hinging window aft of galley
- Blinds or sunscreens to all windows and doors
- LED overhead and task lighting (24v)
- 220/240v outlets (4)
- Timber-laid flooring

ACCOMMODATION

- All cabins and bathrooms feature opening portholes
- All cabins feature 220/240v power points
- All bathrooms feature electric freshwater toilets and 240v shaver points

MASTER STATEROOM

- Large double bed with drawers below
- Twin bedside tables
- Wardrobe with shelves and mirror
- Dressing table
- Pull out mirror to vanity unit
- Occasional table with seats fore and aft
- Storage lockers and drawers
- Fusion MS-SRX400 paired with Fusion 6" MS-CL602 speakers (2)
- Panoramic windows including opening porthole with venetian blinds
- LED overhead and concealed lighting (24v)
- Individual berth lights
- 220/240v outlets (2)
- USB connection points (at each berth) (2)
- Fitted carpet
- En-suite bathroom
- Wash basin with Solid Surface vanity top

- Mirror
- Storage lockers
- Shower compartment with automatic pump out
- Extractor fan
- Window with opening porthole and venetian blind
- LED overhead and concealed lighting (24v)
- Bathroom accessories
- Solid Surface flooring

FORWARD STATEROOM

- Large double bed with drawers below
- Wardrobe with shelves and mirror
- Dressing table
- Mirror to vanity unit
- Storage lockers
- Window with opening porthole and venetian blind
- Deck hatch
- LED overhead and concealed lighting (24v)
- Individual berth lights
- 220/240v outlets (2)
- USB connection points (at each berth) (2)
- Fitted carpet
- En-suite bathroom
- Wash basin with Solid Surface vanity top

- Mirror
- Storage lockers
- Shower compartment with automatic pump out
- Extractor fan
- Window with opening porthole and venetian blind
- LED overhead and concealed lighting (24v)
- Bathroom accessories
- Solid Surface flooring

STARBOARD GUEST CABIN

- Two single beds with drawers below (with option of double bed conversion)
- Bedside table
- Wardrobe with shelves
- Mirror
- Storage lockers and drawers
- Window with opening portholes and venetian blind
- LED overhead and concealed lighting (24v)
- Individual berth lights
- 220/240v outlets (2)
- USB connection points (at each berth) (2)
- Fitted carpet

OPTIONAL AFT CABIN (IN PLACE OF AFT LAZARETTE)

- Single bed with storage below
- Wardrobe with shelf
- Mirror
- LED overhead lighting (24v)
- Individual berth lights
- 220/240v outlet (1)
- Fitted carpet
- En-suite bathroom
- Wash basin with Solid Surface vanity top (in main cabin area)
- Storage lockers
- Opening porthole
- Shower with automatic pump out
- Extractor fan
- LED overhead lighting (24v)
- Bathroom accessories

POWER AND DRIVE SYSTEMS

- 5-bladed propellers in nickel aluminum bronze
- Bow thruster is 130kgf/286lbf with dual-station controls
- Engine room lighting
- Engine room access hatch and ladder
- Power-assisted electro-hydraulic steering

- system
- Trim tabs with indicators
- Electronic engine and gear shift controls
- Engine room extractor fans with electronic time delay
- Fresh water supply point in engine room
- Dripless self-aligning shaft seals

ELECTRICAL SYSTEMS

24 Volt:

- 4 x heavy duty batteries for engine starting
- 4 x heavy duty auxiliary batteries
- Battery link facility with remote control at helm position
- Both battery banks are charged using a voltage sensitive relay that parallels both battery banks when a charging source is present
- 60-amp battery charger
- Remote battery master switches with control switch at main switch panel
- Circuit breakers on all circuits
- 12v voltage dropper for certain navigation and radio circuits

220/240 Volt:

- 9.5Kw diesel generator in own sound shield with water cooled specially silenced exhaust
- Automatic fire extinguisher situated in the engine room
- 50-amp shore support inlet
- Generator/shore support change-over switch
- Polarity check system
- Earth leakage safety trip
- Circuit breakers on all circuits
- Power points in: Owner's stateroom, guest cabins, galley and saloon area
- Shaver points in all bathrooms

FUEL SYSTEM

- Twin fuel tanks (in NS8 marine grade alloy) with interconnection system giving 605 gal/726 US gal/2,750l capacity
- Fuel fillers on port and starboard side decks
- High-capacity duplex fuel filters with water traps with change-over valves
- Water warning sensors connected to warning lights at lower helm
- Remote fuel cocks in cockpit locker
- Fuel gauges at main helm console

WATER SYSTEM

- Water tanks totalling 136 gal/164 US gal/620l plus 16 gal/19 US gal/73l hot water calorifier
- Water heated by engines and 240v immersion heater
- Automatic water pump with filter
- Main circuit breaker at switch panel
- Water level gauge
- Deck filler
- Electric freshwater toilet system with 69 gal/83 US gal/315l holding tank, content gauge and manual overboard discharge, with macerator backup system as well as dockside discharge system

FIRE EXTINGUISHERS

- Automatic/manual override fire extinguishers in engine room with warning system at helm position
- Hand-operated fire extinguishers (5) in owner's stateroom, forward and starboard guest cabin, galley and helm position
- Additional extinguisher fitted when optional aft cabin is specified

BILGE PUMPS

- Automatic/manual override electric bilge pumps in engine room (2), lazarette and forward accommodation (5 in all)
- High-capacity manual bilge pump with valve system and suction points in same areas
- Electric bilge pumps have controls and warning lights at main helm and warning light with audible alarm at flybridge helm

OTHER STANDARD EQUIPMENT

- Ensign staff
- Fenders (6)
- Mooring warps (4)
- Boat hook
- First Aid kit
- Tool kit
- Owner's manual and engine manual
- Quilted bedspreads supplied to all cabins (except optional crew cabin)
- Ship's document case
- Anchor winch back up handle

FINISHES

- Teak-laid decks to transom platform, steps to side decks, cockpit deck and steps to flybridge
- Timber-laid floor to galley area
- Furniture in choice of Rovere oak or Alba oak in satin lacquer finish as standard. Silver oak or walnut in satin or gloss lacquer finishes available as an option.
- Solid Surface floors in all bathroom suites in guest accommodation
- Solid Surface wash basin and counter tops in all bathrooms
- Galley counter top in Solid Surface finish
- Exterior flybridge helms seat upholstery in Comfort Exterior as standard
- Additional exterior upholstery in white vinyl as standard, with optional upgrade to Comfort Exterior available
- Choice of high-quality carpet and upholstery fabric from extensive range
- Blinds or sunscreens to all windows and portholes
- Optional crew cabin has carpet and crew bathroom has white Solid Surface vanity tops and GRP flooring