

V

CLASS





EXPERIENCE THE
EXCEPTIONAL

Your yacht is an extension of yourself. A statement of your lifestyle. She needs to deliver unforgettable experiences for you, your family and friends. Every Princess yacht is designed with our forward-thinking mentality and crafted with meticulous attention to detail. So whether you're dashing across the water or moored in your favourite bay, you will recognise the difference our design and details make, inside and out.

Experience the exceptional.



CRAFTED IN PLYMOUTH

Perched on the edge of the English Channel lies the city of Plymouth, where we established our home in 1965. Today Princess shipyards cover an area of over 1.1 million square feet, an area rich in British maritime heritage. In fact, South Yard, where our X Class Super Flybridge yachts are constructed, is a former naval yard dating back to the 17th century. From the outset, our goal has been to meticulously sculpt our yachts around our owners' enjoyment of them. Such dedication and attention to detail resonates deeply with our Plymouth craftspeople.

Over 3,000 people, each possessing a mastery of their skill, fastidiously realise this vision in our shipyards. Through a culture of innovation, our yachts are not only some of the most technically-advanced in the world but also the most beautifully realised.



DEEPLY INGENUOUS THE PRINCESS DEEP-V HULL

Our pioneering deep-V hulls are born from our naval architect's obsession with exceptional seakeeping and voluminous space. Their sculpted form is shaped from a lightweight, resin-infused hull composite which can create greater internal volume compared to standard hull production methods. This ingenious design ensures it requires less power and burns less fuel to achieve its maximum design speed. Such precision thinking gives rise to the most exhilarating performance, defined by its efficiency, agility and poise. So whether you're slicing through the seas at 40 knots or navigating stormy waters - a foundation of superior engineering rides with you.

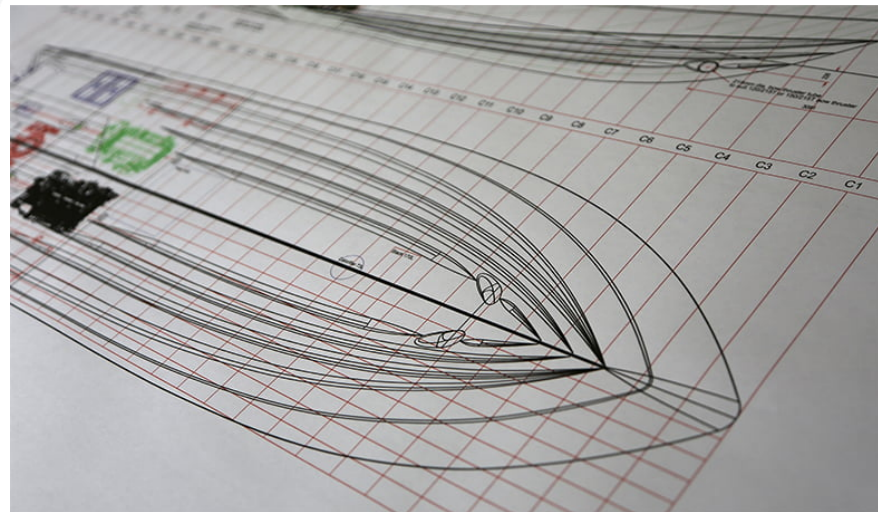



V CLASS

Take the helm and the variable geometry of the deep-V hull assuredly translates any surge of power into taut handling. Enjoy a spirited dash across the ocean in a Princess V Class, a paradox of responsive power and exclusive luxury.





V40



The V40 quintessentially showcases the sleek exterior, performance and exceptional seakeeping of the Princess V Class range. Her port light windows cascade across the length of her deep-V hull, flooding the saloon and cabins with natural light. When entertaining, her spacious cockpit provides the perfect setting with the option to specify a convertible sunbed aft.





Below deck, her interior design depicts the modern V Class look throughout. Her spacious saloon and well equipped galley combine for a highly sociable entertaining space, while both cabins exude contemporary style and generous proportions. The forward cabin has an en-suite bathroom with secondary access to the saloon whilst the aft cabin can be fitted with optional sliding berths to provide easy conversion to a double bed when required.





EXPERIENCE THE V40



TAKE A VIRTUAL TOUR OF THE V40





V40
SPECIFICATION

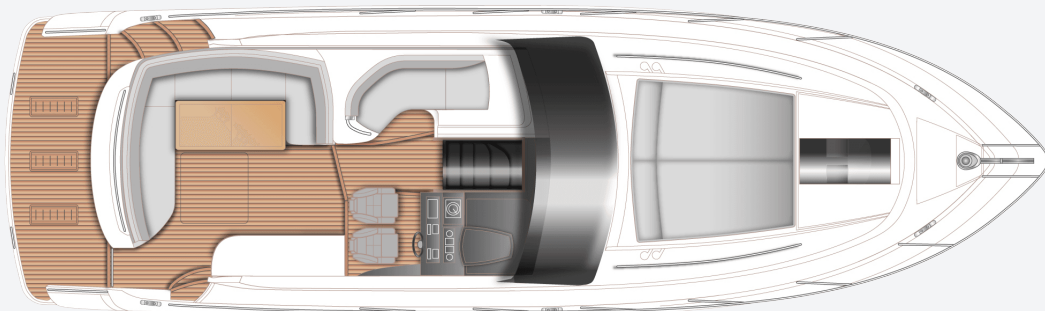

V40 Main Deck

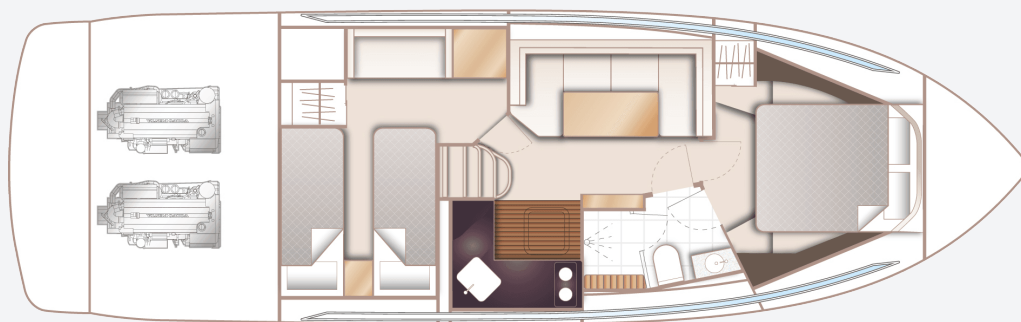

V40 Lower Deck

PRINCIPAL DIMENSIONS

Length overall (incl. pulpit)	42ft 6in (12.98m)
--------------------------------------	-------------------

Length overall (excl. pulpit)	41ft 6in (12.65m)
--------------------------------------	-------------------

Beam	12ft 5in (3.81m)
-------------	------------------

Draft (Drives lowered)	3ft 4in (1.02m)
-------------------------------	-----------------

Displacement approx. (half load)	10,145kg (22,366lbs)*
---	--------------------------

Fuel capacity	160 gal/192 US gal/ 730l
----------------------	-----------------------------

Water capacity (incl. calorifier)	71 gal/85 US gal/ 322l
--	---------------------------

ENGINES

Twin Volvo D6-340 (2 x 340hp)	Speed range: 34-36 knots†
--------------------------------------	------------------------------

FULL SPECIFICATION

DECK FITTINGS

- Teak laid transom platform, cockpit deck and steps to side decks
- Reversible electric anchor winch with helm position controls
- Self-stowing (16 kg/35 lbs) Delta anchor with 30m of chain
- Stemhead roller with automatic anchor launch and retrieve
- Chain locker with stowage for 4 fenders (stowage for an additional 2 fenders in engine room)
- Stainless steel bow, stern and spring cleats
- Bow fairleads
- Stainless steel pulpit and guardrails
- Foredeck hatch with integrated skylight
- Rubbing band with stainless steel insert
- Full set of IMCO navigation lights
- Riding light
- Remote control searchlight
- Twin electric horns
- Fuel and water fillers

COCKPIT

- Self draining
- L-shaped seat opposite helm position
- U-shaped seating/dining area
- Teak table (with optional conversion to double sunbed)
- Cockpit lighting
- Audio unit linked to saloon with local control, paired with Fusion 6" FR-602 speakers (2)
- Sliding sun roof (electrically operated) within fixed GRP structure and integrated radar arch
- Aft tonneau canvas cover
- Stainless steel grabrails
- Wetbar with sink, top loading cool box and optional electric barbecue
- Locker with remote fuel cocks
- 220/240v shore support inlet
- Life raft storage locker
- Engine access hatch with gas strut support and storage for 2 fenders
- Transom gate leading to integral bathing platform
- Teak laid bath platform with retractable

- swimming ladder (manual), hot and cold transom shower, and space for tender
- Large transom storage locker with access via transom doors and hatch in stern seat (will accept deflated dinghy and outboard engine)

HELM POSITION

- Double helm seat with sit/stand facility
- Instrument console incorporating engine instruments and fuel gauges
- Instruments and controls at helm position:
 - Power-assisted electro-hydraulic steering
 - Adjustable steering wheel
 - Electric anchor winch remote control
 - Trim tab controls with indicators
 - Sterndrive trim controls
 - VHF with DSC R/T
 - Speed and distance log (with sea temperature)
 - Echo sounder with alarm
 - Remote control searchlight
 - High-speed compass
 - Horn button

- Chart table
- Windscreen wipers (2 speed)
- Freshwater windscreen wash
- Bilge pump controls with visual 'pump running' warnings

SALOON

- U-shaped sofa, converting to double berth with built in stowage for infill cushions
- Dining table
- Cocktail cabinet
- Cupboards and lockers
- Fusion Apollo RA-670 audio unit with WiFi and Bluetooth connected to saloon Fusion 6" CL602 speakers and cockpit speakers (2)
- Window with opening porthole
- Manual tension venetian blind
- LED overhead and concealed lighting (12v)
- Access stairway to lower accommodation
- Fitted carpet

GALLEY

- Solid surface worktop
- 2-zone gas hob with flame-failure device
- Combination microwave/conventional oven with grill

- Stainless steel sink with mixer tap
- Waste bin
- Drawers and storage cupboards
- Refrigerator with freezer compartment
- Window with opening porthole
- Manual tension venetian blind
- LED overhead and task lighting (12v)
- 220/240v outlets (4)
- Timber flooring

ACCOMMODATION

- All cabins and bathrooms feature opening portholes
- All cabins feature 220/240v power points
- All bathrooms feature electric freshwater toilets and 240v shaver points

OWNER'S CABIN

- Large double bed with drawers below
- Wardrobe with shelves
- Dressing table
- Mirror
- Storage lockers and drawers
- Window with opening porthole
- Manual tension venetian blind
- Deck hatch with integrated skylight and blind

- LED overhead and concealed lighting (12v)
- Individual berth lights
- 220/240v outlets (2)
- Fitted carpet

EN-SUITE BATHROOM

- Wash basin with solid surface worktop
- Mirror
- Storage lockers
- Shower compartment with automatic pump out
- Window with opening porthole
- Manual tension venetian blind
- LED overhead and concealed lighting (12v)
- Bathroom accessories
- Solid surface flooring

GUEST CABIN

- Two single berths
- Wardrobe with shelves
- Mirror
- Storage lockers
- Panoramic with opening porthole
- Manual tension venetian blind
- LED overhead and concealed lighting (12v)
- Individual berth lights
- 220/240v outlets (2)

- Fitted carpet

GAS

- Overboard vented and drained locker for 2 gas bottles
- Copper gas line sheathed in PVC
- Gas regulator
- Gas low/system test meter

POWER AND DRIVE SYSTEMS

- Twin duo-prop stern drives
- Engine room lighting
- Engine room access hatch and ladder
- Power-assisted electro-hydraulic steering system
- Trim tabs with indicators
- Electronic engine and gear shift controls
- Engine room extraction

ELECTRICAL SYSTEMS

12 Volt:

- 2 x heavy duty batteries for engine starting
- 2 x heavy duty auxiliary batteries
- Battery link facility with remote control at helm position
- Both battery banks are charged using a voltage

sensitive relay that parallels both battery banks when a charging source is present

- 75-amp 12v float battery charger
- Remote battery master switches with control switch at main switch panel
- Circuit breakers on all circuits
- 12v voltage dropper for certain navigation and radio circuits

220/240 Volt:

- Automatic fire extinguisher
- 30-amp shore support inlet
- Polarity check system
- Earth leakage safety trip
- Circuit breakers on all circuits
- Power points in: owner's cabin, guest cabin, galley and saloon area
- Shaver point in bathroom

FUEL SYSTEM

- Twin fuel tanks (in NS8 marine grade alloy) with interconnection system giving 160 gal / 192 US gal / 730l capacity
- Fuel fillers on port and starboard side decks
- Volvo fuel filter/ water separator (one per engine) with water warning sensors connected

to warning lights at helm position

- Remote fuel cocks in cockpit locker
- Fuel gauges at main helm console

WATER SYSTEM

- Water tanks totalling 64 gal / 77 US gal / 290l plus 7 gal / 8.5 US gal / 32l hot water calorifier
- Water heated by engines and 240v immersion heater
- Automatic water pump with filter
- Main circuit breaker at switch panel
- Water level gauge
- Deck filler

FIRE EXTINGUISHERS

- Automatic/manual override fire extinguishers in engine room with warning system at helm position
- Hand-operated fire extinguishers (4) in owner's cabin, guest cabin, galley and helm position

BILGE PUMPS

- Automatic/manual override electric bilge pumps in engine room (2), rudder area, lazarette and forward accommodation (6 in all)
- High-capacity manual bilge pump with valve

system and suction points in same areas

- Electric bilge pumps have controls and warning lights at main helm and warning light with audible alarm at flybridge helm

OTHER STANDARD EQUIPMENT

- Ensign staff
- Fenders (6)
- Mooring warps (4)
- Boat hook
- First-aid kit
- Tool kit
- Owner's manual and engine manual
- Quilted bedspreads supplied to both cabins
- Ship's document case
- Anchor winch back up handle

FINISHES

- Teak-laid decks to transom platform, cockpit deck and steps to side decks
- Timber-laid floor to galley area
- Furniture in choice of Rovere Oak or Alba Oak in satin lacquer finish as standard. Silver Oak or Walnut in satin or gloss lacquer finish available as an option
- Tiled floor in bathroom suite in guest

accommodation

- Solid surface wash basin counter tops in bathroom suite in guest accommodation
- Galley worktop in solid surface finish
- Choice of high-quality carpet and upholstery fabric from extensive range
- Blinds or sunscreens to all windows and portholes